

# Hypertherm®

## MAX100D Machine torch parts

### PAC160 consumables



MAX100D



MAX100D machine torch

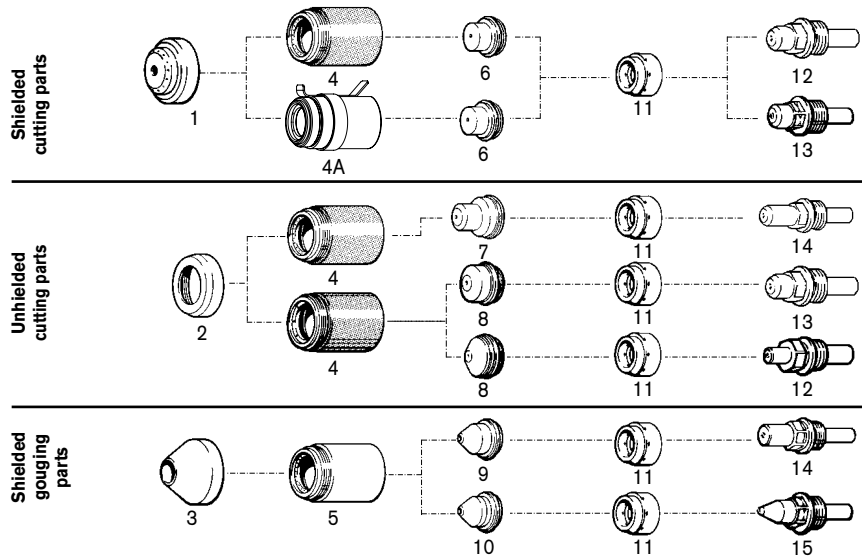

	DESCRIPTION	PART NUMBER CURRENT RATING			QUANTITY PER PACKAGE
		100 AMPS	60 AMPS	30/40 AMPS	
Shielded cutting parts	12 Electrode, Air,	120433	120433	_____	5
	13 Electrode, N <sub>2</sub>	020193	020193	_____	5
	11 Swirl Ring	020706	020706	_____	1
	6 Nozzle	020705	120336	_____	5
	4 Retaining Cap	020846	020756	_____	1
	4A Retaining Cap, Ohmic	120969	_____	_____	1
	1 Shield	020334	020492	_____	1
Unshielded cutting parts	12 Electrode, Air	_____	120433**	020951	5
	13 Electrode, N <sub>2</sub>	_____	020193	_____	5
	11 Swirl Ring	_____	020706	020950	1
	8 Nozzle	_____	020922	020921	5
	4 Retaining Cap	_____	020756	020756	1
	2 Deflector	_____	020333	020333	1
	14 Electrode, Air, Extended	120444**	_____	_____	1
14 Electrode, N <sub>2</sub> , Extended	020887	_____	_____	1	
11 Swirl Ring	020706	_____	_____	1	
7 Nozzle, Extended	020754	_____	_____	1	
4 Retaining Cap	020846	_____	_____	1	
2 Deflector	020333	_____	_____	1	
Shielded gouging parts	14 Electrode, Air, Extended	020744	_____	_____	5
	15 Electrode, H <sub>35</sub>	020703	_____	_____	5
	11 Swirl Ring	020750	_____	_____	1
	9 Nozzle, Air	020745	_____	_____	5
	10 Nozzle, H <sub>35</sub>	020704	_____	_____	5
	5 Retaining Cap	020699	_____	_____	1
3 Shield	020712	_____	_____	1	

## MAX100D PAC160/E machine torch assembly

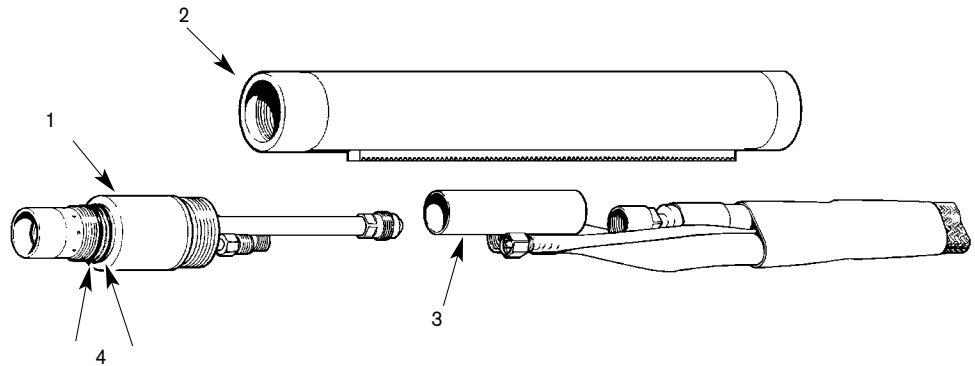

MAX100D machine torch

ITEM NUMBER	PART NUMBER	DESCRIPTION
	028596^	MAX100D Machine Torch Assembly
1	020713	MAX100D Machine Torch Main Body
2	020243	MAX100D Torch Positioning Sleeve
3	020468	Negative Lead Insulator, 1/16 x 3 1/2"
4	058019	O-Ring: Viton .801 x .071 (two required)
	059115^	MAX100D Machine Torch Assembly, 25' / 7.6 m Leads
	059116^	MAX100D Machine Torch Assembly, 50' / 15.2 m Leads
	059117^	MAX100D Machine Torch Assembly, 75' / 22.9 m Leads
	028555	MAX100D Machine Torch Leads, 25' / 7.6 m
	028556	MAX100D Machine Torch Leads, 50' / 15.2 m
	028557	MAX100D Machine Torch Leads, 75' / 22.9 m
	028910	MAX100D Quick Disconnect Assembly
	002190	Boot, 80/100 Amp Quick Disconnect

^ Assembly includes consumables