

# FineCut™ Consumables

***"I'm elated with the new nozzles. The difference is as clear as night vs. day. The new nozzles provide a cleaner, smoother cut that makes my life much easier. My customers immediately noticed and like the improved products."***

**Cole Wagley,  
Prairie Outfitters**

FineCut consumables are an innovative addition to Hypertherm's industry-leading line of plasma cutting torches. They deliver significant increases in cut quality by providing a narrower kerf – with virtually no heat-affected zone – and by dramatically reducing dross. Hand-torch and machine-torch operators who choose FineCut consumables consistently achieve superior metal finishing and increased productivity.

## Core benefits of FineCut technology

- Better overall finish on both mild and stainless steel resulting from a decreased heat-affected zone

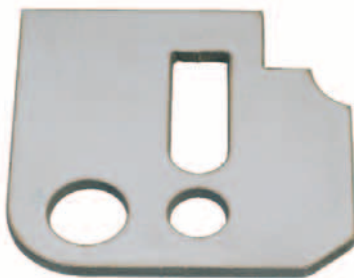

- Finer cut quality than standard nozzles made possible by narrower kerf width and improved cut angularity

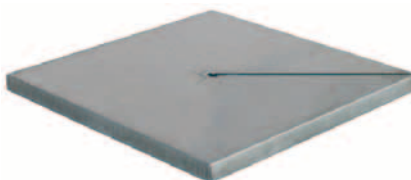

- Elimination of some secondary operations because of virtually dross-free cutting



## FineCut consumables benefit many common applications

- HVAC
- Sign fabrication and installation
- Metal sculpting and ornamental work
- Commercial kitchen installation
- Beverage fountain installation
- Cart and shelf fabrication
- Tank and container fabrication
- Door and elevator fabrication and installation

**Hypertherm®**

# Order a FineCut kit today

If you are looking for even better cut quality on thin-plate metals using your Hypertherm systems . . . order a starter kit today and begin experiencing the FineCut difference!



## FineCut starter kits

Description	Part number
Powermax600	128886
Powermax600 CE	128887
Powermax1000/1250/1650	128888
Powermax1000/1250/1650 CE	128889

**Kits include:** 5 nozzles, 2 swirl rings, 5 electrodes, 5 o-rings, 1 deflector and 1 tube of silicone lubricant.

## Individual consumable parts

### Powermax350/380, MAX20

Item number	Part number	Description
1	220016	Retaining cap
2	220331	Nozzle, PAC110, FineCut
3	020382	Electrode, extended
4	220013	Swirl ring

## Operating data

Material	Thickness		Torch standoff		Current amps	Approximate travel speed		Arc voltage volts
	GA	mm	in.	mm		ipm	mm/min	
Mild steel	10	3.4	.08	2.0	50	90	2286	76
	10	3.4			40	50	1270	83
	12	2.7			45	120	3048	77
	12	2.7			40	70	1778	81
	14	1.9			40	135	3810	79
	16	1.5			40	150	3810	79
	18	1.2			40	150	3810	79
	20	0.9			40	120	2540	78
Stainless steel	24	0.6	.01	.25	30	150	3810	80
	10	3.4			50	80	1905	63
	10	3.4			40	60	1524	73
	12	2.7			45	100	3174	63
	12	2.7			40	80	1905	72
	14	1.9			40	150	3810	65
	16	1.5			40	150	3810	64
	18	1.2			40	150	3810	64
20	0.9	40	150	3810	65			
24	0.6	30	150	3810	66			

### Powermax600/800/900, MAX40cs/42/43

Item number	Part number	Description
1	120303	Deflector
2	220326	Deflector, CE, FineCut
3*	220403	Shield, ohmic, FineCut
4	120600	Retaining cap
5*	120964	Retaining cap, ohmic
6	220330	Nozzle, PAC123, FineCut
7	120574	Electrode, extended
8	220332	Swirl ring, hand, FineCut
9	120576	Swirl ring, machine

Extended unshielded parts

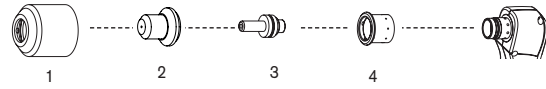

### Powermax1000/1250/1650

Item number	Part number	Description
1	120979	Deflector
2	220325	Deflector, CE, FineCut
3	220404	Shield, ohmic, FineCut
4	120928	Retaining cap
5	220061	Retaining cap, ohmic
6	220329	Nozzle, T60/T80/T100, FineCut
7	120926	Electrode
8	220327	Swirl ring, hand, FineCut
9	120925	Swirl ring, machine

Extended unshielded parts

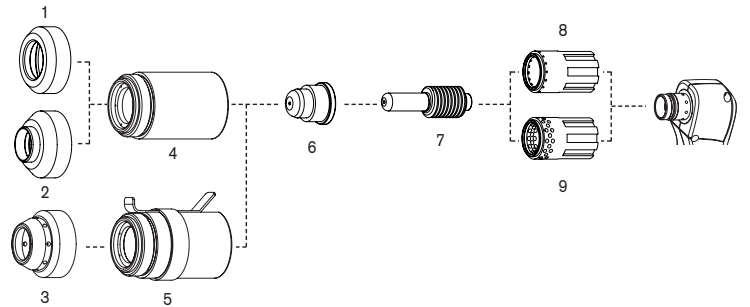
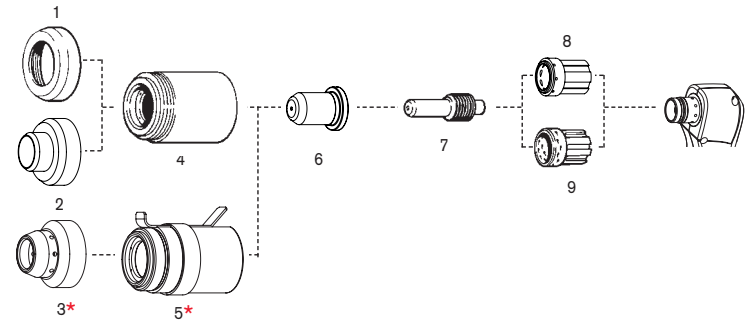

# Hypertherm®

**Hypertherm, Inc.**  
Hanover, NH 03755 USA  
603-643-3441 Tel

**Hypertherm (S) Pte Ltd.**  
417847, Republic of Singapore  
65 6 841 2489 Tel

**Hypertherm (Shanghai)  
Consulting Co., Ltd.**  
P.R. China 200120  
86-21-5835-5362 /3 Tel

**Hypertherm Europe B.V.**  
4704 SE Roosendaal, Nederland  
31 165 59 69 07 Tel

**HYPERTHERM BRASIL LTDA.**  
Guarulhos, SP - Brasil  
55 11 6482 1087 Tel

[www.hypertherm.com](http://www.hypertherm.com)

\* Not for use on the Powermax600